

Plan
M-2505A

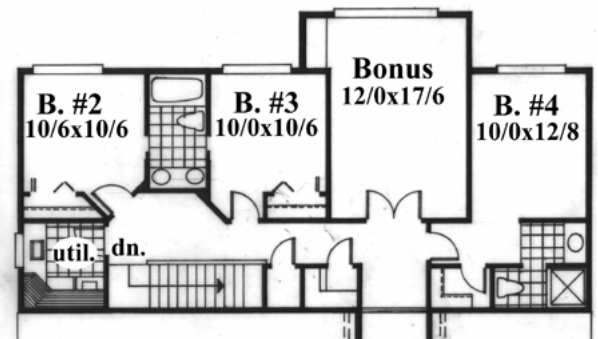
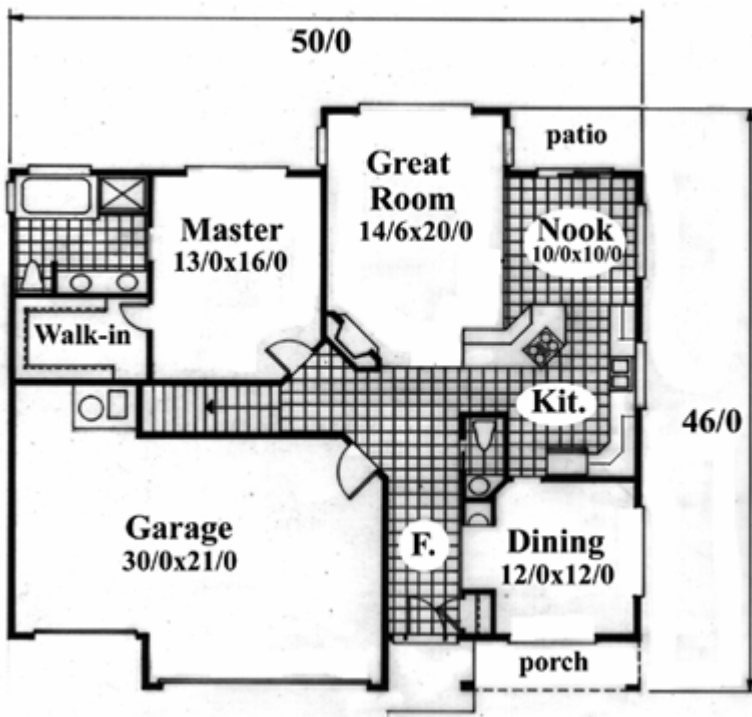

Plan
M-2505A

50/0 wide x 46/0 deep
2,505 sq. ft.

"This design has all the charm of the traditional country designs of our past with a timely contemporary "great room" floor plan. There are four bedrooms, a large bonus room and wonderful Great Room here. Notice the master bedroom on the main level as well as the three car garage. All of this with the front porch and dormers make this plan (only 50 feet wide) a cost effective and heart warming addition to any neighborhood."